

Coude 90° mâle conique orientable - RPC MR



Filetage mâle BSPT

R 1/8

Pour tube Ø ext. (mm)

4

Pression d'utilisation

0 à 10 bar

Température

0°C à + 60°C

Matière

Polymère et laiton nickelé

Description

| Référence | Filetage mâle BSPT | Pour tube Ø ext. (mm) |
|-------------------|--------------------|-----------------------|
| RPC MR0400 | R 1/8 | 4 |
| RPC MR0401 | R 1/4 | 4 |
| RPC MR0500 | R 1/8 | 5 |
| RPC MR0501 | R 1/4 | 5 |
| RPC MR0502 | R 3/8 | 5 |
| RPC MR0503 | R 1/2 | 5 |
| RPC MR0600 | R 1/8 | 6 |
| RPC MR0601 | R 1/4 | 6 |

| Référence | Filetage mâle BSPT | Pour tube Ø ext. (mm) |
|------------|--------------------|-----------------------|
| RPC MR0602 | R 3/8 | 6 |
| RPC MR0603 | R 1/2 | 6 |
| RPC MR0800 | R 1/8 | 8 |
| RPC MR0801 | R 1/4 | 8 |
| RPC MR0802 | R 3/8 | 8 |
| RPC MR0803 | R 1/2 | 8 |
| RPC MR1000 | R 1/8 | 10 |
| RPC MR1001 | R 1/4 | 10 |
| RPC MR1002 | R 3/8 | 10 |
| RPC MR1003 | R 1/2 | 10 |
| RPC MR1201 | R 1/4 | 12 |
| RPC MR1202 | R 3/8 | 12 |
| RPC MR1203 | R 1/2 | 12 |
| RPC MR1402 | R 3/8 | 14 |
| RPC MR1403 | R 1/2 | 14 |
| RPC MR1602 | R 3/8 | 16 |
| RPC MR1603 | R 1/2 | 16 |

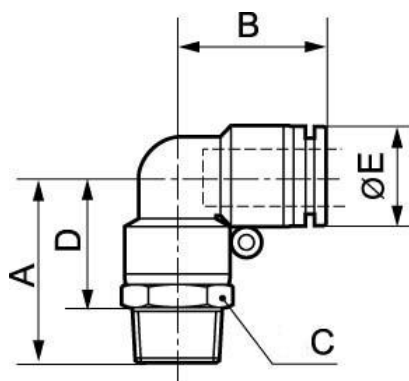

Dimensions

| Référence | A mm | B mm | C mm | D mm | E mm |
|-------------------|------|------|------|------|------|
| RPC MR0400 | 25 | 17.5 | 10 | 17.5 | 10 |
| RPC MR0401 | 26.5 | 17.5 | 14 | 17.5 | 10 |
| RPC MR0500 | 27.5 | 20.5 | 12 | 20 | 12.8 |
| RPC MR0501 | 29 | 20.5 | 14 | 20 | 12.8 |
| RPC MR0502 | 31.5 | 20.5 | 17 | 20.5 | 12.8 |
| RPC MR0503 | 34 | 20.5 | 21 | 21 | 12.8 |
| RPC MR0600 | 27.5 | 20.5 | 12 | 20 | 12.8 |
| RPC MR0601 | 29 | 20.5 | 14 | 20 | 12.8 |
| RPC MR0602 | 31.5 | 20.5 | 17 | 20.5 | 12.8 |
| RPC MR0603 | 34 | 20.5 | 21 | 21 | 12.8 |
| RPC MR0800 | 29.5 | 22.5 | 14 | 22 | 13.8 |
| RPC MR0801 | 31 | 22.5 | 14 | 22 | 13.8 |
| RPC MR0802 | 33.5 | 22.5 | 17 | 22.5 | 13.8 |
| RPC MR0803 | 36 | 22.5 | 21 | 23 | 13.8 |
| RPC MR1000 | 33.2 | 26.3 | 17 | 25.7 | 16.8 |

| Référence | A mm | B mm | C mm | D mm | E mm |
|-------------------|------|------|------|------|------|
| RPC MR1001 | 34.7 | 26.3 | 17 | 25.7 | 16.8 |
| RPC MR1002 | 36.7 | 26.3 | 17 | 25.7 | 16.8 |
| RPC MR1003 | 39.2 | 26.3 | 21 | 26.2 | 16.8 |
| RPC MR1201 | 35.5 | 27.8 | 19 | 26.5 | 19.8 |
| RPC MR1202 | 38 | 27.8 | 19 | 27 | 19.8 |
| RPC MR1203 | 40 | 27.8 | 21 | 27 | 19.8 |
| RPC MR1402 | 40 | 29.8 | 22 | 29 | 22.7 |
| RPC MR1403 | 42 | 29.8 | 22 | 29 | 22.7 |
| RPC MR1602 | 41.5 | 30.8 | 24 | 30.5 | 23.8 |
| RPC MR1603 | 43.5 | 30.8 | 24 | 30.5 | 23.8 |