

PPS GSQ - SQ Profile grey

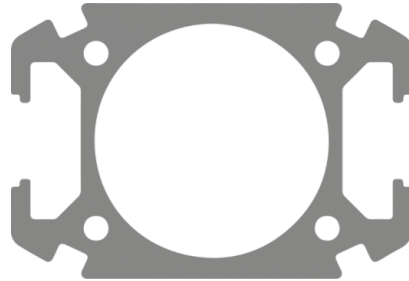

<u>Pipe ID (in)</u> 1"	<u>Length (ft)</u> 3.28	<u>Technology</u> PPS Grip Concept	<u>Operating pressure</u> 0 to 232 psi
<u>Vacuum capability</u> -29 inHg (vacuum 98%)	<u>Temperature</u> -4°F to +176°F	<u>Construction</u> Pipe and fittings: aluminum	<u>Highlight</u> Scalable system
<u>Meets standards</u> ASME B31.3 REACH			

Description		
Référence	Tube Ø int (mm)	Long. (m)
PPS GSQ2510	25	1
PPS GSQ2520	25	2

